



R410A變頻式
分體冷氣機

遙控器 操作說明書

室內機型號：

RS-S9KI

RS-S12KI

RS-S18KI

室外機型號：

RU-S9KI

RU-S12KI

RU-S18KI

重要提示：

感謝您購買我們的冷氣機。在操作您的新冷氣機之前，請仔細閱讀本說明書。請務必保存本說明書以供將來參考。

目錄

遙控器型號及主要參數.....	2
遙控器的處理.....	3
遙控器各按鈕功能.....	4
遙控器顯示屏介紹.....	5
如何使用基本功能.....	6
如何使用進階功能.....	10

遙控器型號及主要參數

型號	RS-S9KI,RU-S9KI RS-S12KI,RU-S12KI RS-S18KI,RU-S18KI
額定電壓	3.0V (兩節 R03/LR03 乾電池)
信號到達距離	8m
使用條件	-5°C ~ 60°C(23°F~140°F)

快速入門指南

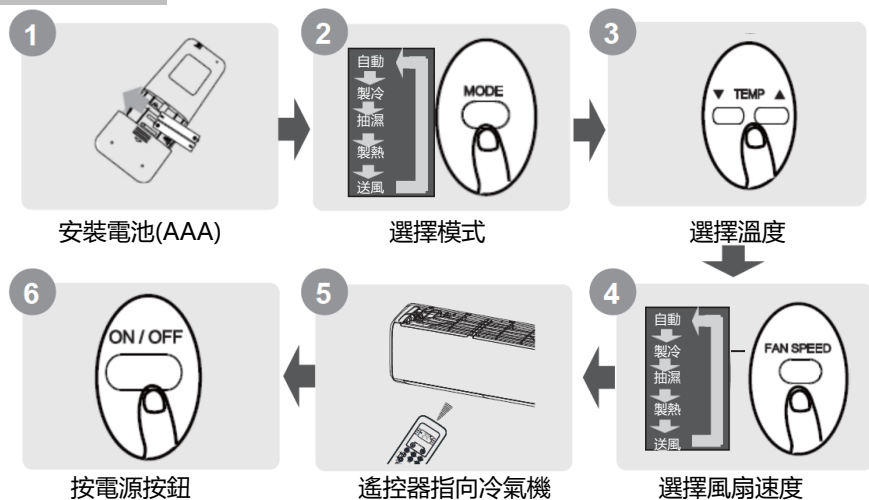

不確定功能是什麼？

有關如何使用冷氣機的詳細說明，請參閱本手冊的“如何使用基本功能”和“如何使用進階功能”部分。

特別說明

- 本機上的按鈕設計可能與所示示例略有不同。
- 如果室內機沒有特定功能，則按遙控器上的該功能按鈕將無效。
- 如“遙控器說明書”和“使用及安裝說明書”中的功能說明有很大差異，則以“使用及安裝說明書”為準。

遙控器的處理

安裝和更換電池

您的冷氣機裝置可能隨附兩枚電池（部分機型）。使用之前，請將電池放入遙控器中。

1. 向下滑動遙控器的後蓋，露出電池盒。
2. 插入電池，注意將電池的 (+) 和 (-) 與電池倉內的符號對齊。
3. 將電池蓋滑回原位。

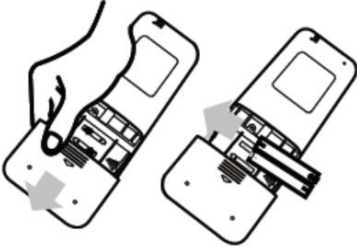

！注意事項

- 不要混合新舊電池或不同類型的電池。
- 如果 2 個月或更長時間都不再使用遙控器，請取出電池。



電池處理

不要將電池作為未分類的垃圾處理。有關正確處理電池，請參閱當地法律。

使用遙控器的提示

- 必須在距離冷氣機 8 米以內使用遙控器。
- 收到遙控信號時，冷氣機會發出蜂鳴聲。
- 窗簾，其他物質和直射的陽光會干擾紅外信號接收器。
- 如果遙控器停止使用超過 2 個月，請取出電池。

使用遙控器的注意事項

該設備能符合當地國家法規。

- 在加拿大，它應符合 CAN ICES-3 (B) / NMB-3 (B) 的要求。
- 在美國，此設備符合 FCC 規則的第 15 部分。操作必須符合以下兩個條件：
 - (1) 本遙控器不會造成有害干擾，並且
 - (2) 本設備必須接受收到的任何干擾，包括可能導致意外操作的干擾。

本設備經測試證明符合 FCC 規則第 15 部分中關於 B 類數字設備的限制。這些限制

在住宅安裝中該設計能提供合理的保護，以防止有害干擾。本設備會產生並使用輻射射頻能量，如果未按照說明進行安裝和使用，可能會對無線電通信造成干擾。但是，不能保證在特定安裝中不會發生干擾。如果此設備確實對無線電或電視接收造成干擾（可以通過打開和關閉設備來確定），用戶可嘗試通過以下一種或多種措施來消除干擾：

- 重新調整或擺放接收天線。
- 增加設備和接收器之間的距離。
- 將設備連接到與接收器不同電路的插座上。
- 請諮詢經銷商或有經驗的廣播/電視技術人員以尋求幫助。
- 未經認可的更改或修改可能會使用戶喪失操作設備的權限。

遙控器各按鈕功能

在開始使用新的冷氣機之前，請確保熟悉其遙控器。以下是遙控器本身的簡要介紹。有關如何操作冷氣機的說明，請參閱本說明書的“如何使用基本功能”部分。

溫度降 ▼ 按鈕

以 1°C (1°F) 的增量降低溫度。最低溫度為 16°C(60°F)。

開/關按鈕

啟動或關閉冷氣機。

模式按鈕

迴圈操作模式如下：
自動-製冷-抽濕-製暖-送風
注意 如果您購買的機器是淨冷型號 請不要選擇 HEAT 模式。淨冷型號不支援製暖模式。

擺風按鈕

開始和停止水平送風葉擺動。按住 2 秒鐘以啟動垂直送風葉自動擺動功能（部分機型）。

睡眠按鈕

自動調節溫度達至睡眠舒適感。

直接按鈕

用於設置送風葉角度。

節能按鈕

用於進入節能模式。

自清洗按鈕

用於啟動/停止自清潔或主動清潔功能。
(取決於型號，請參閱用戶的使用及安裝說明)

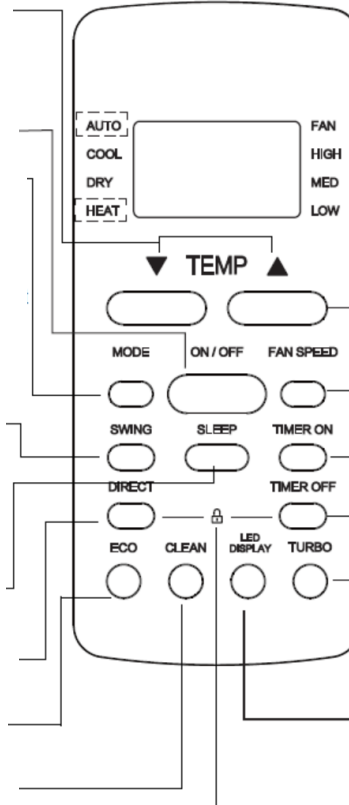

溫度升 ▲ 按鈕

以 1°C (1°F) 的增量增加溫度。最高溫度為 30°C (86°F)。
注意：同時按下 ▲ & ▼ 按鈕 3 秒鐘將在 °C 和 °F 之間交替顯示溫度。

風速按鈕

在以下順序選擇風速：
自動 - 低速 - 中速 - 高速

定時按鈕

設置計時器以開啟設備 (請參閱如何使用基本功能指示)。

定時按鈕

設置計時器以關閉設備 (請參閱如何使用基本功能指示)。

增強按鈕

使設備能夠在盡可能短的時間內達到預設溫度。

LED 顯示按鈕

打開和關閉室內機的 LED 顯示屏和冷氣機蜂鳴器 (取決於型號)，從而營造舒適 安靜的環境。

童鎖按鈕

同時按下 DIRECT 和 TIMER OFF 按鈕 5 秒鐘以鎖定鍵盤。同時按住兩個按鈕 2 秒鐘以解鎖鍵盤。

型號:

RS-S9KI,RU-S9KI

RS-S12KI,RU-S12KI

RS-S18KI,RU-S18KI

遙控器顯示屏介紹

當初次安裝電池時，顯示屏會點亮所有信息。



Mode display

AUTO ▼ COOL ◀ DRY ◀
HEAT ▲ ▼ FAN

-  數據傳輸時顯示
-  遙控器啟動時顯示

-  設置定時器開啟時間時顯示
-  設置定時器關閉時間時顯示
-  顯示設定溫度或房間
-  溫度或計時器設置下的時間
-  啟動 ECO 功能時顯示

-  表示所有當前設置被鎖定
-  啟動 Follow Me 功能時顯示(部分機型)
-  啟動睡眠功能時顯示
-  啟動 FRESH 功能時顯示(部分機型)
-  啟動 TRUBO 功能時顯示
-  水平送風葉自動擺動顯示
-  垂直送風葉自動擺動顯示(部分機型)

風扇轉速顯示

- ▶ HIGH 高速
- ▶ MED 中速
- ▲ LOW 低速
- NO display 自動風速

注意：

圖中顯示的所有指標都是為了清楚表述。但是在實際操作期間，在顯示窗口中僅顯示相對功能符號。

如何使用基本功能

注意！在操作之前，請確保冷氣機已接通電源。

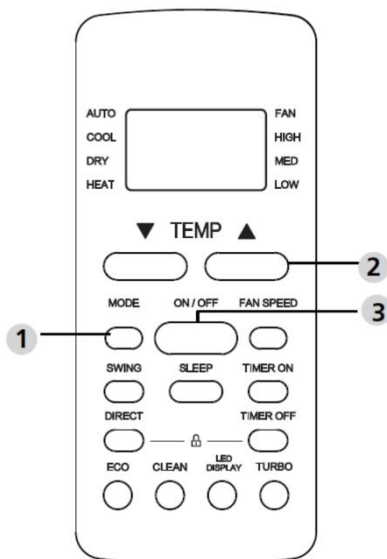

製冷模式

1. 按 MODE 按鈕選擇 **COOL 製冷**
2. 按溫度 \wedge 或 \vee 按鈕設置所需的溫度
3. 按 FAN 按鈕調節風速範圍：
自動—低速-中速或高速
4. 按 ON / OFF 按鈕啟動冷氣機

設定溫度

冷氣機的工作溫度範圍是 16-30°C (60-86°F) / 20-28 °C (60-82°F)。

您可以以 1°C (1°F) 的增量增加或減少設定溫度。

自動模式

在自動模式下，冷氣機將根據設定溫度自動選擇製冷，送風和製暖模式(不適用於淨冷型號)。

1. 按 MODE 按鈕選擇 **AUTO 自動**
2. 按溫度 \wedge 或 \vee 按鈕設置所需的溫度
3. 按 ON / OFF 按鈕啟動冷氣機

注意：在自動模式下，無法調整風速

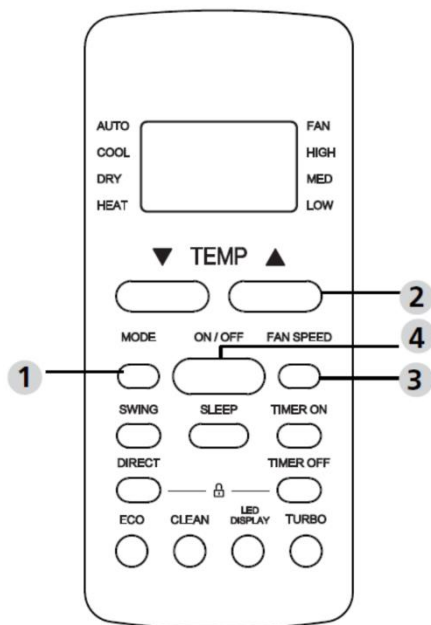

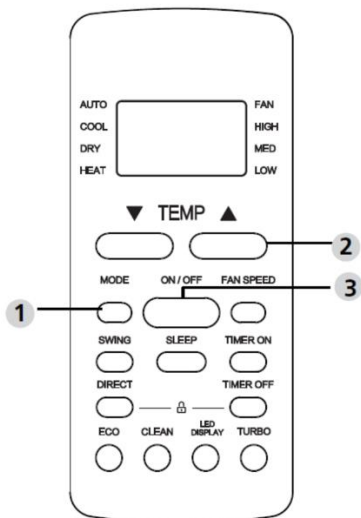

抽濕模式

1. 按 MODE 按鈕選擇 **DRY 抽濕**
2. 按溫度 \wedge 或 \vee 按鈕設置所需的溫度
3. 按 ON / OFF 按鈕啟動冷氣機

注意：在抽濕模式下，無法調整風速

送風模式

1. 按 MODE 按鈕選擇 **FAN 送風模式**
2. 按 FAN 按鈕調節風速範圍：
自動-低速-中速-高速
3. 按 ON / OFF 按鈕啟動冷氣機

注意：您無法在 FAN 模式下設置溫度而遙控器的 LCD 屏幕將不會顯示溫度

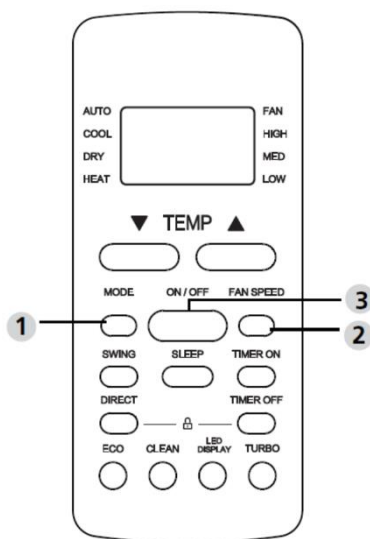

定時功能設置

定時開機/關機--設置冷氣機將自動打開/關閉的時間。

定時開機設置

按 TIMER 按鈕啟動開啟時間序列。



按溫度調節上或下按鈕多次，以設置開啟冷氣機所需的時間。



將遙控器指向冷氣機並等待 1 秒鐘，將開啟定時開機功能。



定時關機設置

按 TIMER 按鈕啟動關閉時間序列。



按溫度調節上或下按鈕多次，以設置關閉冷氣機所需的時間。

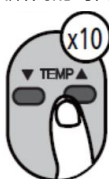

將遙控器指向冷氣機並等待 1 秒鐘，將開啟定時關機功能。



注意：

1. 設定 **TIMER ON 定時開機**或 **TIMER OFF 定時關機**時，每按一次，時間將增加 30 分鐘，最多增加 10 個小時。10-24 小時之間，它將以 1 小時為增量增加。(例如，按 5 次獲得 2.5h，然後按 10 次獲得 5h，) 計時器將在 24 點後恢復為 0.0。
2. 通過將其計時器設置為 0.0h 來取消任一功能。

定時器開與關設置 (示例)

請記住，為這兩個功能設置的時間段是指當前時間之後的小時數。

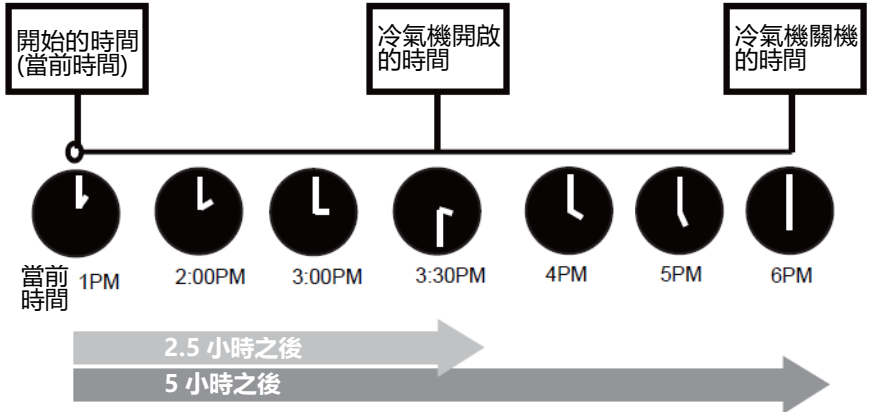
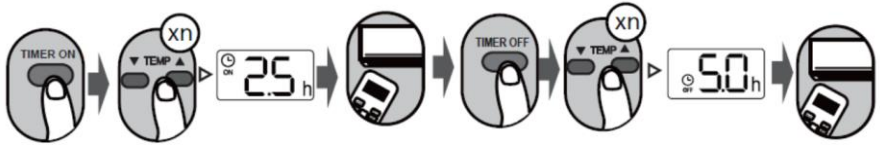

示例: 如果當前計時器為 1:00 PM, 則要按上述步驟設置計時器, 本機將在 2.5h (3:30 PM) 之後打開, 並在 6:00 PM 關閉。

如何使用進階功能

擺風功能

按擺風 **SWING** 按鈕

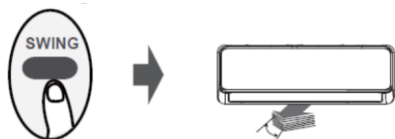

按一下 **SWING** 搖擺 按鈕，水平送風葉將自動上下搖擺。
再按一次使其停止。



按住此按鈕 2 秒鐘以上，將激活垂直送風葉擺動功能。(取決於型號)

氣流方向

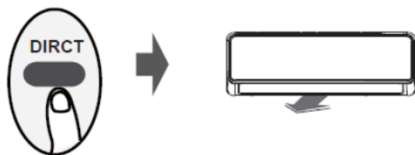

每按一次按鈕，百葉窗就會調整 6°。
按下按鈕，直至達到您喜歡的角度。

LED 顯示屏

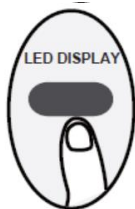

按一下 LED 按鈕

按下此按鈕可以打開和關閉
室內機上的顯示屏。



按住 LED 按鈕 5 秒鐘
以上 (部分機型)

按住此按鈕 5 秒鐘以上，室內機
將顯示實際的室溫。再按 5 秒鐘
以上將恢復顯示設定溫度。

ECO 節能功能



按 ECO 按鈕以進入節能模式。

注意：此功能僅在製冷模式下有效。

在製冷模式下，按此按鈕，遙控器會自動將溫度調節到 24°C/75°F，自動風扇速度，此狀態可以節省能源（但僅限設定溫度小於 24°C/75°F 時）。如果設定溫度高於 24°C/75°F，按 ECO 按鈕，風扇速度將變為自動，設定溫度將保持不變。

注意：

按下 ECO 按鈕，修改模式或將設定溫度調節到 24°C / 75°F 以下將停止 ECO 操作。在 ECO 模式下，設定溫度應為 24°C / 75°F 或更高，這可能會導致冷卻不足。如果您感到不舒服，只需再次按 ECO 按鈕即可將其停止。

睡眠模式



SLEEP 功能用於自動調節溫度達至睡眠舒適感（並且不需要相同的溫度設置來保持舒適）。此功能只能通過遙控器啟動。

睡眠功能在風扇或乾燥模式下不可用。有關詳細信息，請參閱使用及安裝說明書。

靜音模式



持續按住 FAN 風扇按鈕 2 秒鐘以上以啟用/停用靜音功能(部分機型)。

由於壓縮機的低頻運行，可能會導致製冷不足。按開/關按鈕，模式按鈕，睡眠按鈕，增強或清潔按鈕將取消靜音功能。

● 特別聲明

1. 以上資料已經過核對；如有任何印刷錯誤或內容方面的誤解，本公司將保留解釋權。
2. 本產品若有技術方面的改進，新版的操作說明中將會加入有關資料，恕不另行通知。產品外觀及顏色以冷氣機實物為準。
3. 本公司可應要求通過電子郵件發送電子版的用戶指南，請致電信興電工工程有限公司熱線電話2861 2767。

● 售後服務

保修期為購買日起計一年。如產品損毀屬正常使用下發生者，本公司可提供免費維修服務。請出示正式收據及蓋有銷售點/換購中心印章的保修證，以享用免費維修服務。如有查詢，請致電信興電器服務中心有限公司熱線電話2406 5666。

如發生以下任何情況，請立即關閉電源並聯絡信興電器服務中心有限公司。

- 斷路器經常跳掣或保險絲常被燒斷。
- 水或異物意外進入冷氣機內。
- 冷氣機操作時發出異常聲音。

信興電工工程有限公司

SHUN HING ELECTRIC WORKS & ENGINEERING CO., LTD

辦公室：香港九龍尖沙咀東部麼地道 67 號半島中心 9 樓

OFFICE: 9/F, PENINSULA CENTRE, 67 MODY ROAD, TSIMSHATSUI EAST,
KOWLOON, HONG KONG

電話 TEL: (852) 2861 2767

傳真 FAX: (852) 2865 6706

網址 WEBSITE: www.rasonic.com

電郵 EMAIL: shew@shunhinggroup.com

保養及維修 MAINTENANCE AND REPAIR SERVICE

信興電器服務中心有限公司

SHUN HING ELECTRIC SERVICE CENTRE LTD.

辦公室：香港新界葵涌勝耀街2號信興中心11樓

OFFICE: 11TH FLOOR, SHUN HING CENTRE, 2 SHING YIU STREET, KWAI CHUNG, NEW
TERRITORIES, HONG KONG

電話 TEL: (852) 2406 5666

傳真 FAX: (852) 2408 0316

網址 WEBSITE: www.shesc.com

消耗品/附件銷售熱線 CONSUMABLES/ ACCESSORIES SALES HOTLINE

電話 TEL: (852) 2406 5666

客戶服務中心 CUSTOMER SERVICE CENTRES

香港新界葵涌勝耀街2號信興中心1樓

1ST FLOOR, SHUN HING CENTRE, 2 SHING YIU STREET, KWAI CHUNG, NEW
TERRITORIES, HONG KONG

電話 TEL: (852) 2406 5439

傳真 FAX: (852) 2408 1389

澳門慕拉士大馬路193-199號南嶺工業大廈5樓I座

AVENIDA DE VENCESLAU DE MORAIS, NO. 193-199, 5 ANDAR-I, EDF. INDUSTRIAL
NAM LENG, MACAU

電話 TEL: (853) 2836 2928

傳真 FAX: (853) 2833 6405

有關最新之客戶服務中心資訊，請參閱信興服務中心網址：www.shesc.com或致電維修服務熱線查詢。

For the latest information of customer service centres, please visit www.shesc.com or call us at our hotline.



R410A INVERTER COOLING
SPLIT-TYPE ROOM

Remote Controller Operation Manual

Indoor Model:

RS-S9KI

RS-S12KI

RS-S18KI

Outdoor Model:

RU-S9KI

RU-S12KI

RU-S18KI

IMPORTANT NOTE:

Thank you for purchasing our air conditioner. Please read this manual carefully before operating your new air conditioning unit. Make sure to save this manual for future reference.

Table of Contents

Remote Controller Specifications	02
Handling the Remote Controller	03
Buttons and Functions	04
Remote Screen Indicators	05
How to Use Basic Functions	06
How to Use Advanced Functions	09

Remote Controller Specifications

Model	RS-S9KI,RU-S9KI RS-S12KI,RU-S12KI RS-S18KI,RU-S18KI
Rated Voltage	3.0V(Dry batteries R03/LR03×2)
Signal Receiving Range	8m
Environment	-5°C~60°C(23°F~140°F)

Quick Start Guide

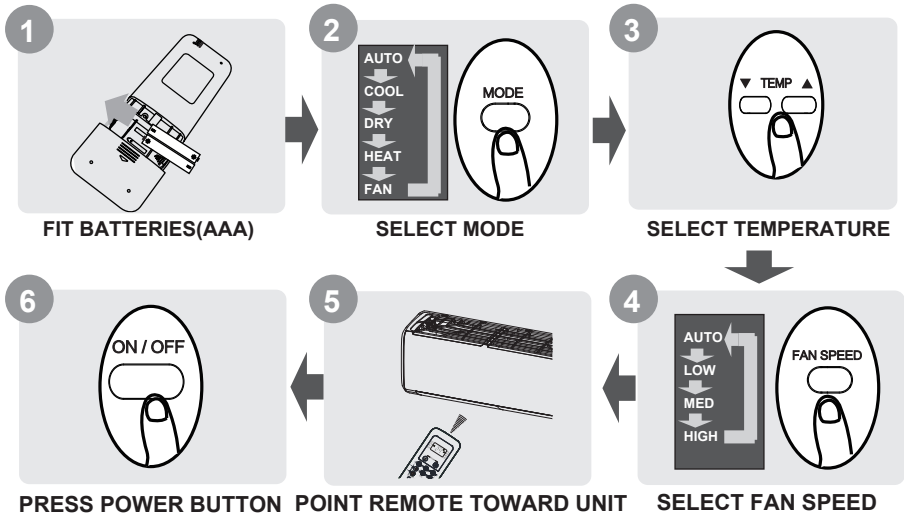

NOT SURE WHAT A FUNCTION DOES?

Refer to the **How to Use Basic Functions** and **How to Use Advanced Functions** sections of this manual for a detailed description of how to use your air conditioner.

SPECIAL NOTE

- Button designs on your unit may differ slightly from the example shown.
- If the indoor unit does not have a particular function, pressing that function's button on the remote control will have no effect.
- When there are wide differences between "Remote controller Manual" and "OPERATION & INSTALLATION MANUAL" on function description, the description of "OPERATION & INSTALLATION MANUAL" shall prevail.

Handling the Remote Controller

Inserting and Replacing Batteries

Your air conditioning unit may come with two batteries(some units). Put the batteries in the remote control before use.

1. Slide the back cover from the remote control downward, exposing the battery compartment.
2. Insert the batteries, paying attention to match up the (+) and (-) ends of the batteries with the symbols inside the battery compartment.
3. Slide the battery cover back into place.

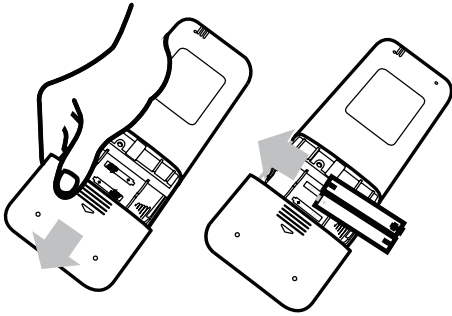

! BATTERY NOTES

For optimum product performance:

- Do not mix old and new batteries, or batteries of different types.
- Do not leave batteries in the remote control if you don't plan on using the device for more than 2 months.



BATTERY DISPOSAL

Do not dispose of batteries as unsorted municipal waste. Refer to local laws for proper disposal of batteries.

TIPS FOR USING REMOTE CONTROL

- The remote control must be used within 8 meters of the unit.
- The unit will beep when remote signal is received.
- Curtains, other materials and direct sunlight can interfere with the infrared signal receiver.
- Remove batteries if the remote will not be used more than 2 months.

CAUTIONS FOR USING REMOTE CONTROL

The device could comply with the local national regulations.

- In Canada, it should comply with CAN ICES-3(B)/NMB-3(B).
- In USA, this device complies with part 15 of the FCC Rules. Operation is subject to the following two conditions:
 - (1) This device may not cause harmful interference, and
 - (2) this device must accept any interference received, including interference that may cause undesired operation.

This equipment has been tested and found to comply with the limits for a Class B digital device, pursuant to part 15 of the FCC Rules. These limits are designed to provide reasonable protection against harmful interference in a residential installation. This equipment generates, uses and can radiate radio frequency energy and, if not installed and used in accordance with the instructions, may cause harmful interference to radio communications. However, there is no guarantee that interference will not occur in a particular installation. If this equipment does cause harmful interference to radio or television reception, which can be determined by turning the equipment off and on, the user is encouraged to try to correct the interference by one or more of the following measures:

- Reorient or relocate the receiving antenna.
- Increase the separation between the equipment and receiver.
- Connect the equipment into an outlet on a circuit different from that to which the receiver is connected.
- Consult the dealer or an experienced radio/TV technician for help.
- Changes or modifications not expressly approved by the party responsible for compliance could void user's authority to operate the equipment.

Buttons and Functions

Before you begin using your new air conditioner, make sure to familiarize yourself with its remote control. The following is a brief introduction to the remote control itself. For instructions on how to operate your air conditioner, refer to the **How to Use Basic Functions** section of this manual.

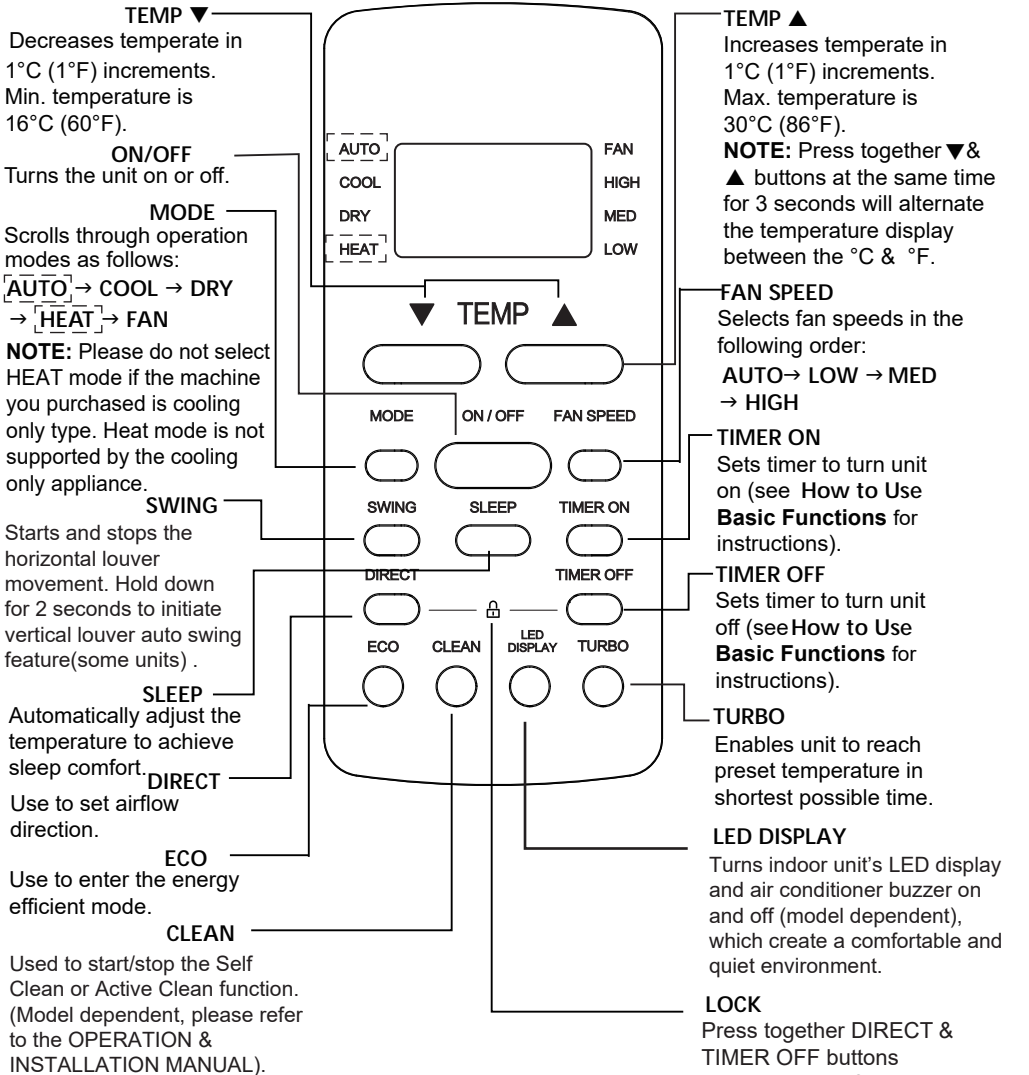

Model: RS-S9KI, RU-S9KI
RS-S12KI, RU-S12KI
RS-S18KI, RU-S18KI



Remote Screen Indicators

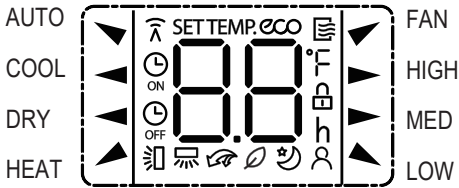



Information are displayed when the remote controller is power up.









Mode display

AUTO ▼ COOL ◀ DRY ◀
HEAT ▲ ▼ FAN

 Displayed when data transmitted.
 Displayed when remote controller is ON.

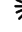
 ON Displayed when TIMER ON time is set
 OFF Displayed when TIMER OFF time is set
 ^{SETTEMP} 00 °F Shows set temperature or room temperature, or time under TIMER setting
 Displayed when ECO feature is activated

 Indicated all the current settings are locked
 Displayed when Follow Me feature is activated(some units)
 Displayed when SLEEP feature is activated
 Displayed when FRESH feature is activated(some units)
 Displayed when TRUBO feature is activated
 Horizontal louver auto swing display
 Vertical louver auto swing display(some units)

Fan speed indication

▶ HIGH High speed
▶ MED Medium speed
▲ LOW Low speed
NO display Auto fan speed

Note:

All indicators shown in the figure are for the purpose of clear presentation. But during the actual operation, only the relative function signs are shown on the display window.

How to Use Basic Functions

Basic operation

ATTENTION! Before operation, please ensure the unit is plugged in and power is available.

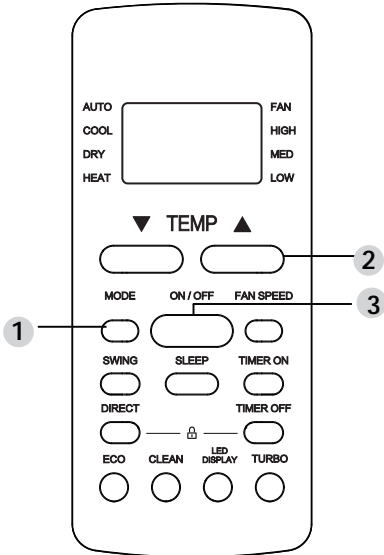

COOL Mode

1. Press the **MODE** button to select **COOL** mode.
2. Set your desired temperature using the **TEMP ▲** or **TEMP ▼** button.
3. Press **FAN** button to select the fan speed: AUTO, LOW, MED or HIGH.
4. Press the **ON/OFF** button to start the unit.

SETTING TEMPERATURE

The operating temperature range for units is 16-30°C (60-86°F)/20-28°C(68-82°F). You can increase or decrease the set temperature in 1°C (1°F) increments.

AUTO Mode

In AUTO mode, the unit will automatically select the COOL, FAN, or HEAT(not applicable for cooling only model) operation based on the set temperature.

1. Press the **MODE** button to select **AUTO**.
2. Set your desired temperature using the **TEMP ▲** or **TEMP ▼** button.
3. Press the **ON/OFF** button to start the unit.

NOTE: FAN SPEED can't be set in AUTO mode.

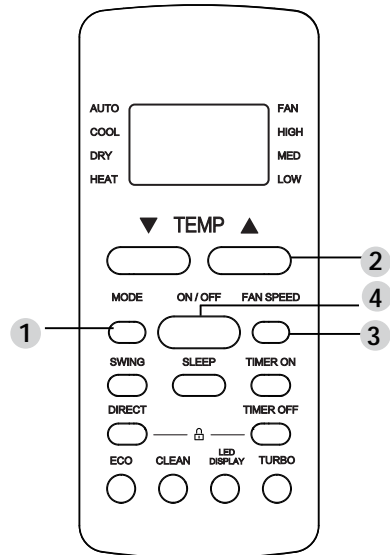

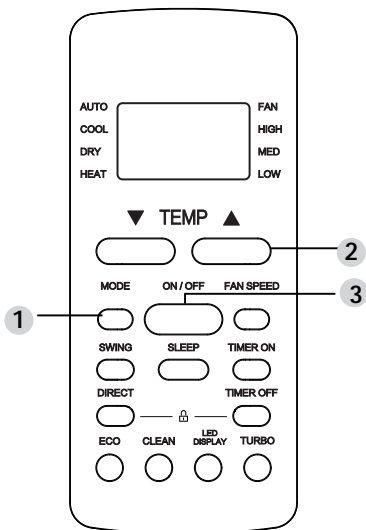

DRY Mode (dehumidifying)

1. Press the **MODE** button to select **DRY**.
2. Set your desired temperature using the **TEMP ▲** or **TEMP ▼** button.
3. Press the **ON/OFF** button to start the unit.

NOTE:FAN SPEED cannot be changed in DRY mode.

FAN Mode

1. Press the **MODE** button to select **FAN** mode.
2. Press **FAN** button to select the fan speed: AUTO, LOW, MED or HIGH.
3. Press the **ON/OFF** button to start the unit.

NOTE:You can't set temperature in FAN mode. As a result, your remote control's LCD screen will not display temperature.

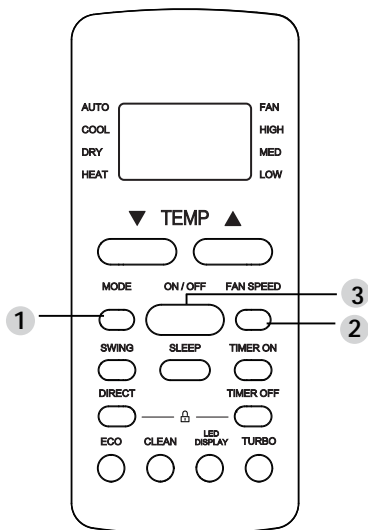

Setting the TIMER

TIMER ON/OFF - Set the amount of time after which the unit will automatically turn on/off.

TIMER ON setting

Press **TIMER ON** button to initiate the ON time sequence.



Press **Temp. up or down** button for multiple times to set the desired time to turn on the unit.

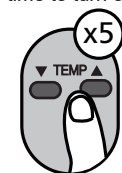

Point remote to unit and wait 1sec, the **TIMER ON** will be activated.



TIMER OFF setting

Press **TIMER OFF** button to initiate the OFF time sequence.



Press **Temp. up or down** button for multiple times to set the desired time to turn off the unit.

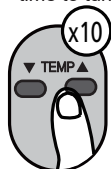

Point remote to unit and wait 1sec, the **TIMER OFF** will be activated.



NOTE:

1. When setting the **TIMER ON** or **TIMER OFF**, the time will increase by 30 minutes increments with each press, up to 10 hours. After 10 hours and up to 24, it will increase in 1 hour increments. (For example, press 5 times to get 2.5h, and press 10 times to get 5h.) The timer will revert to 0.0 after 24.
2. Cancel either function by setting its timer to 0.0h.

TIMER ON & OFF setting(example)

Keep in mind that the time periods you set for both functions refer to hours after the current time.

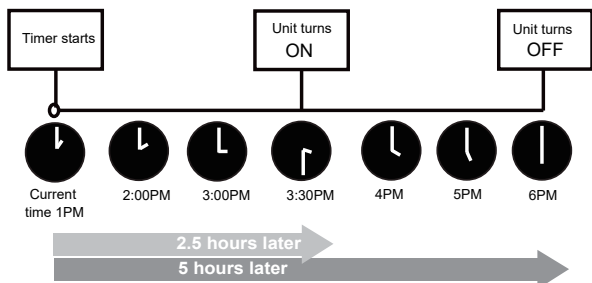
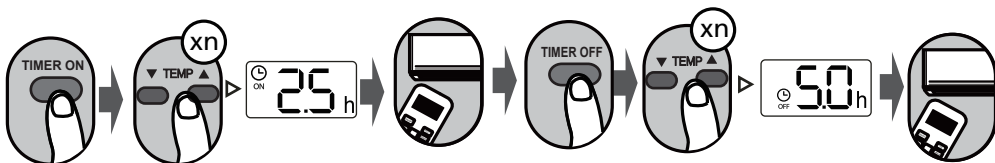

Example: If current timer is 1:00PM, to set the timer as above steps, the unit will turn on 2.5h later (3:30PM) and turn off at 6:00PM.

How to Use Advanced Functions

Swing function

Press Swing button

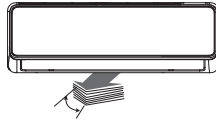

The horizontal louver will swing up and down automatically when pressing Swing button. Press again to make it stop.

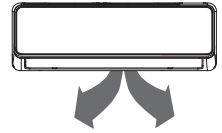

Keep pressing this button more than 2 seconds, the vertical louver swing function is activated. (Model dependent)

Airflow direction



Each time you press the button, it will adjust the louver by 6°. Press the button until the direction you prefer is reached.

LED DISPLAY

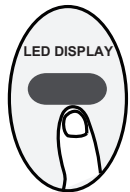

Press LED button

Press this button to turn on and turn off the display on the indoor unit.

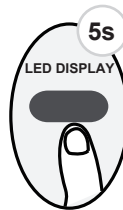

Press this button more than 5 seconds (some units).

Keep pressing this button more than 5 seconds, the indoor unit will display the actual room temperature. Press more than 5 seconds again will revert back to display the setting temperature.

ECO function



Press this button under COOL Mode to enter the energy efficient mode.

Note: This function is only available under COOL mode.

Under cooling mode, press this button, the remote controller will adjust the temperature automatically to 24°C/75°F, fan speed of Auto to save energy (only when the set temperature is less than 24°C/75°F). If the set temperature is above 24°C/75°F, press the ECO button, the fan speed will change to Auto, the set temperature will remain unchanged.

NOTE:

Pressing the ECO button, or modifying the mode or adjusting the set temperature to less than 24°C/75°F will stop ECO operation.

Under ECO operation, the set temperature should be 24°C/75°F or above, it may result in insufficient cooling. If you feel uncomfortable, just press the ECO button again to stop it.

SLEEP function



The SLEEP function is used to automatically adjust the temperature to achieve sleep comfort (and don't need the same temperature settings to stay comfortable). This function can only be activated via remote control. The sleep function is not available in Fan or Dry mode. Please refer to the OPERATION & INSTALLATION MANUAL for more details.

Silence function



Keep pressing Fan button for more than 2 seconds to activate/disable Silence function (some units).

Due to low frequency operation of compressor, it may result in insufficient cooling capacity. Press ON/OFF, Mode, Sleep, Turbo or Clean button while operating will cancel silence function.

● Special Avowal

- 1. The information above has been checked; our company reserves the hermeneutic power to any print errors or misunderstanding on the content.**
- 2. Any technology improvement will add into new instruction without any prior notices. The product appearance and color refer to the practical air conditioner.**
- 3. The e-copy of user manual can be sent by e-mail on requested, please call Shun Hing Electric Works & Engineering Co. Ltd. hotline at 2861 2767.**

● After sale service

Guarantee period state from the date of purchasing to one year. If the product is damaged under proper use, a free repair service is available. Please present the official invoice and the guarantee certificate with the sales point's chop / redemption center's chop for free maintenance. For enquiries, please contact Shun Hing Electric Service Centre Limited hotline at 2406 5666.

Turn off the power and contact Shun Hing Electric Service Centre Ltd. as soon as any of the following events occur.

The circuit breaker frequently trips or the fuse blows regularly.

If water or foreign objects have accidentally entered the air conditioner.

If there is abnormal sound during operation.

信興電工工程有限公司

SHUN HING ELECTRIC WORKS & ENGINEERING CO., LTD

辦公室：香港九龍尖沙咀東部麼地道 67 號半島中心 9 樓

OFFICE: 9/F, PENINSULA CENTRE, 67 MODY ROAD, TSIMSHATSUI EAST,
KOWLOON, HONG KONG

電話 TEL: (852) 2861 2767

傳真 FAX: (852) 2865 6706

網址 WEBSITE: www.rasonic.com

電郵 EMAIL: shew@shunhinggroup.com

保養及維修 MAINTENANCE AND REPAIR SERVICE

信興電器服務中心有限公司

SHUN HING ELECTRIC SERVICE CENTRE LTD.

辦公室：香港新界葵涌勝耀街2號信興中心11樓

OFFICE: 11TH FLOOR, SHUN HING CENTRE, 2 SHING YIU STREET, KWAI CHUNG, NEW
TERRITORIES, HONG KONG

電話 TEL: (852) 2406 5666

傳真 FAX: (852) 2408 0316

網址 WEBSITE: www.shesc.com

消耗品/附件銷售熱線 CONSUMABLES/ ACCESSORIES SALES HOTLINE

電話 TEL: (852) 2406 5666

客戶服務中心 CUSTOMER SERVICE CENTRES

香港新界葵涌勝耀街2號信興中心1樓

1ST FLOOR, SHUN HING CENTRE, 2 SHING YIU STREET, KWAI CHUNG, NEW
TERRITORIES, HONG KONG

電話 TEL: (852) 2406 5439

傳真 FAX: (852) 2408 1389

澳門慕拉士大馬路193-199號南嶺工業大廈5樓I座

AVENIDA DE VENCESLAU DE MORAIS, NO. 193-199, 5 ANDAR-I, EDF. INDUSTRIAL
NAM LENG, MACAU

電話 TEL: (853) 2836 2928

傳真 FAX: (853) 2833 6405

有關最新之客戶服務中心資訊，請參閱信興服務中心網址：www.shesc.com或致電維修服務熱線查詢。

For the latest information of customer service centres, please visit www.shesc.com or call us at our hotline.